

RAPID BAR TIE

15mm and 20mm formwork tie system

Code	Description	Weight (Kg)
07804	Rapid Bar Tie Knock on Wing Nut (SWL = 110 kN)	0.35

Code	Description	Weight (Kg)
07803	Standard Waler Plate - Orange (SWL = 80 kN)	1.34
07802	Light Duty Waler Plate - Plated (SWL = 55 kN)	1.10

Code	Description	Weight (Kg)
07754	Hi Rapid Bar Tie Wing Nut (SWL = 215 kN)	0.44

Code	Description	Weight (Kg)
07841	Rapid Bar Tie Hexagon Nut 50mm	0.18
07772	Hexagon Nut for 20mm System (SWL = 110 kN (15mm dia.) SWL = 160 kN (20mm dia.))	0.40

Code	Description	Weight (Kg)
01871	Hi-Load Waler Plate (SWL = 160 kN)	6.76

Code	Description	Weight (Kg)
07800	Rapid Tie Plastic Cones 10mm	0.01
07750	Hi Rapid Tie Plastic Cone 26 dia. Tube	0.01

Code	Description	Weight (Kg)
08940	Aquafix Stopper 26mm	0.01
08941	Aquafix Stopper 20mm	0.01
08942	Aquafix Stopper 22mm	0.01
08943	Aquafix Stopper 32mm	0.01

Code	Description	Weight (Kg)
09683	Tiesal Cone 22 x 50mm	0.03
07752	Tiesal Cone 26 x 50mm	0.03

Code	Description	Weight (Kg)
07842	Rapid Tie Cast Water Bar (SWL = 110 kN)	0.54

Code	Description	Weight (Kg)
07810	Rapid Bar Tie	
07811	15mm Bar x 1m	1.44
07812	Rapid Bar Tie	
07813	15mm Bar x 1.75m	2.48
07814	Rapid Bar Tie	
07819	15mm Bar x 2.5m	2.83
07820	Rapid Bar Tie	
07823	15mm Bar x 5.8m	8.50
07823	Rapid Bar Tie	
07823	15mm Bar per metre	1.50
07773	Rapid Bar Tie	
07773	20mm Bar x 5.8m (SWL = 110 kN (15mm dia.) SWL = 200 kN (20mm dia.))	16.00

Code	Description	Weight (Kg)
08938	Flexihose 19/25mm x 30m	7.50
08944	Hi-Load Flexihose 25/31mm x 30m	9.56

Code	Description	Weight (Kg)
07840	Rapid Tie Connector (SWL = 110 kN)	0.41
07771	20mm Rapid Tie Connector (SWL = 215 kN)	0.90

Code	Description	Weight (Kg)
07845	Rapid Anchor Mk1 (SWL = 40 kN)	0.30

Code	Description	Weight (Kg)
07801	Rapid Tie Plastic Tube 22/26 x 2m	0.47
07751	Hi Rapid Tie Plastic Tube 26/30 x 2m	0.92

Code	Description	Weight (Kg)
02319	Heavy Duty Waler Plate (SWL = 110 kN)	2.00

Code	Description	Weight (Kg)
07938	Angle Waler Plate 1" (SWL = 80 kN)	1.40

Code	Description	Weight (Kg)
07839	Rapid Tie 15mm Weld-on Anchor (SWL = 90 kN)	0.50

Code	Description	Weight (Kg)
04991	Hydraulic Kit for Rapid Bar Tie Anchor	25.00

Code	Description	Weight (Kg)
07838	Rapid Tie Ribbed Water Bar connector (SWL = 110 kN)	0.58

Code	Description	Weight (Kg)
07843	Rapid Tie Concrete Anchor (SWL = 80 kN)	0.30

For installation, refer to data sheet 41.

Code	Description	Weight (Kg)
07832	Rapid Tie She Bolt 700mm (SWL = 110 kN) (50mm cover to cast in Tie)	1.50
07834	Rapid Tie She Bolt 725mm (SWL = 110 kN) (75mm cover to cast in Tie)	1.75

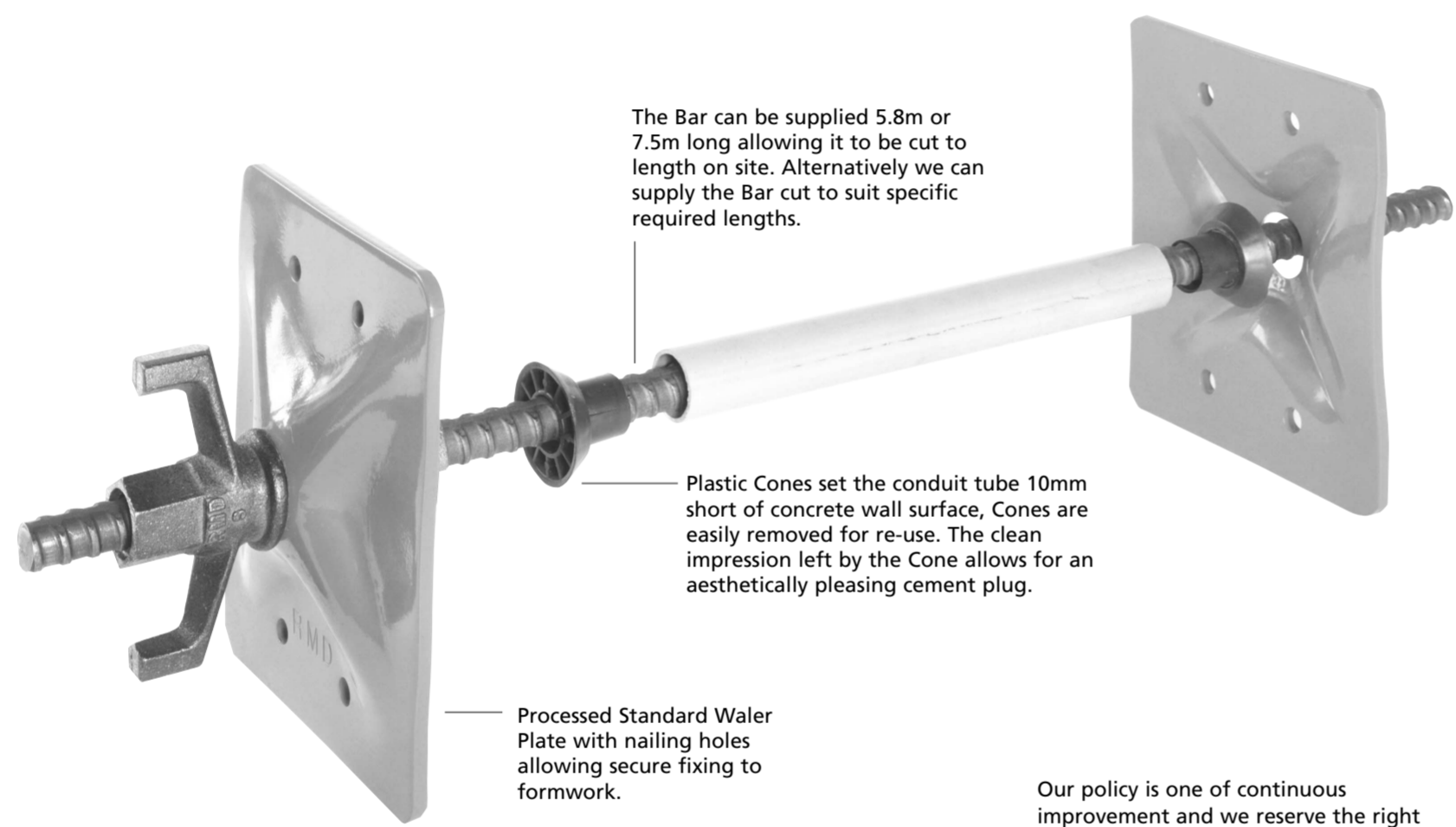

Our policy is one of continuous improvement and we reserve the right to change, alter or modify any detail, design, weight, dimension or code without prior notice being given.

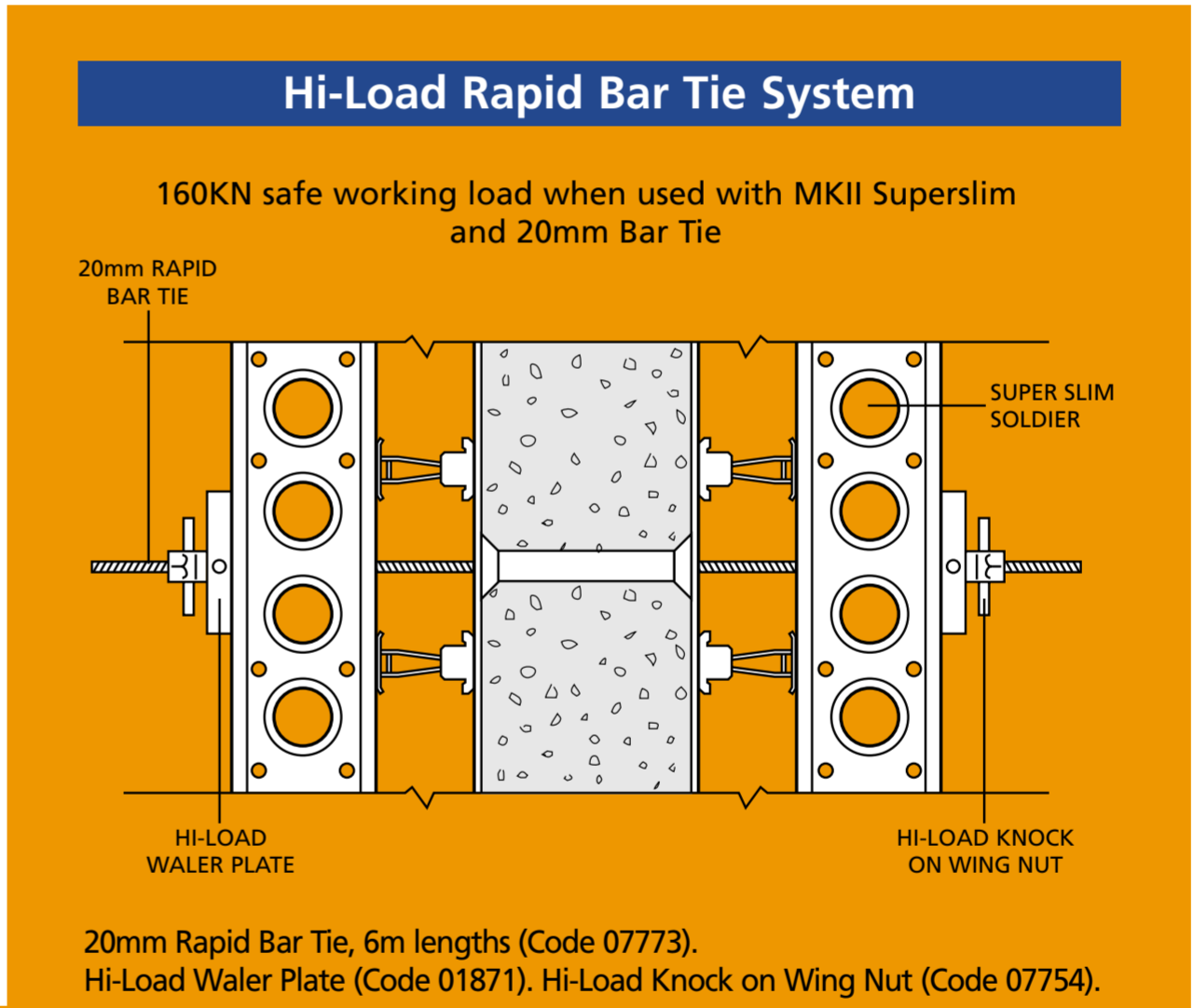

Rapid Bar Tie 'She Bolt System'

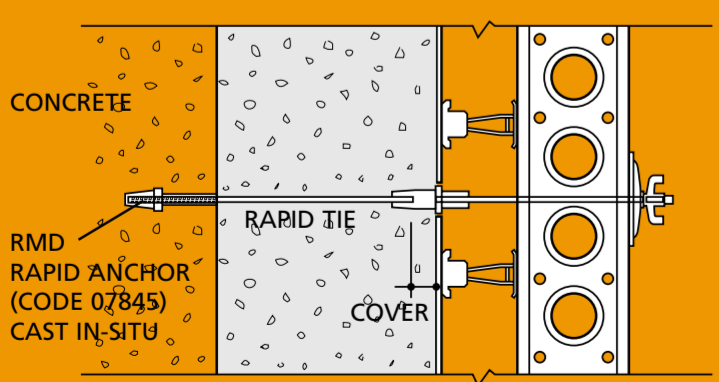

Single Faced Application
Using cast in anchor

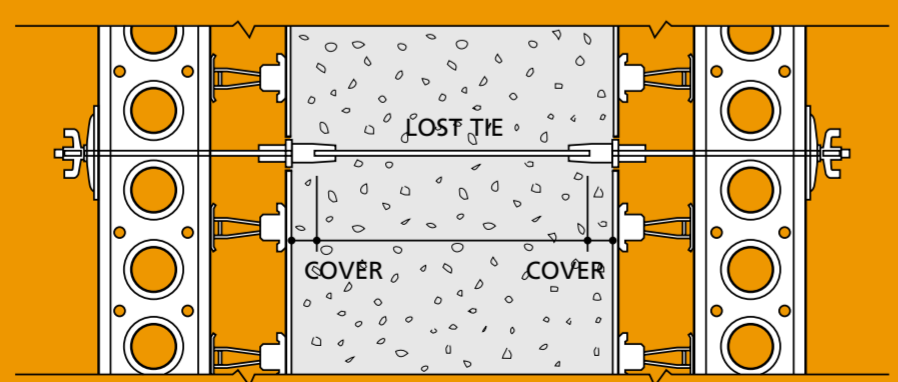

Double Faced Application
Cover, either 50mm (Code 07832) or 75mm (Code 07834)
Lost Tie is 15mm Rapid Bar Tie (cut to suit)

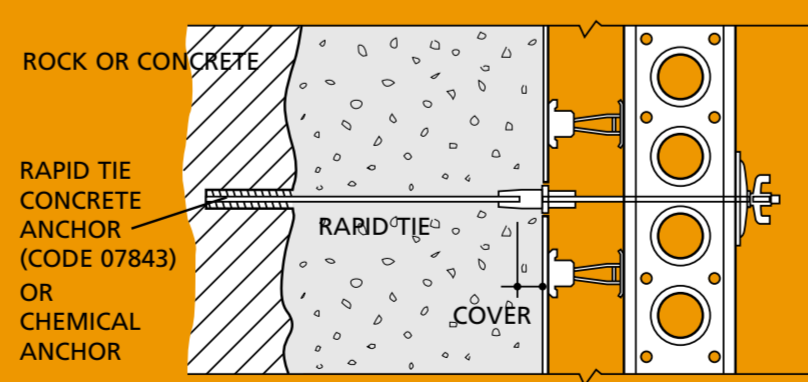

Single Faced Application
Using mechanical or chemical anchor into existing face

Kickerless Construction

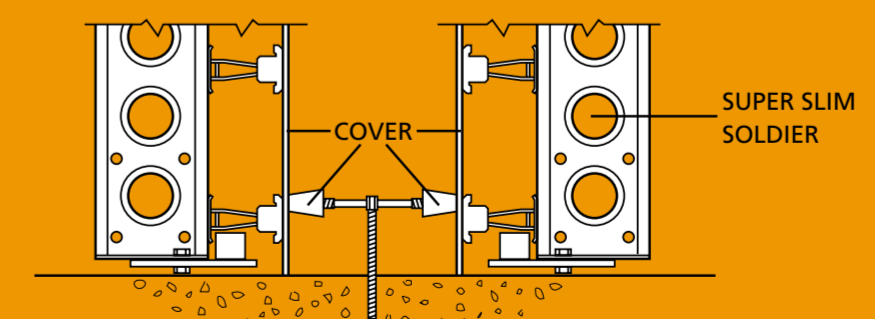

Support Leg (Code 08681). Concrete End Caps (Code 08689).
Threaded horizontal bar (Code 08682-08688 and 08691).
End caps give 50mm cover threaded bar length determined by wall: all thickness less 100mm.

R.M.D KWIKFORM

Head Office Ireland

RMD Kwikform.
Ballyboggan Road,
Finglas, Dublin 11, Ireland.
Tel: 01 830 2500
Fax: 01 830 2741
E-mail: rmd.dublin@rmdkwikform.com

Cork Branch
Nyhan Industrial Estate,
Tramore Road, Cork.
Tel: 021 496 6188
Fax: 021 496 6475
E-mail: rmd.cork@rmdkwikform.com

Ballinasloe Branch
Kilclooney,
Ballinasloe, Co. Galway.
Tel: 0905 42196
Fax: 0905 42950
E-mail: rmd.ballinasloe@rmdkwikform.com

Belfast Branch
Boucher Place,
Balmoral Industrial Estate,
Boucher Road,
Belfast, BT12 6HT.
Tel: 028 9038 1771
Fax: 028 9038 1328
E-mail: rmd.belfast@rmdkwikform.com

www.rmdkwikform.com

A member of Interserve Plc.